

Partes do produto:

1. Corpo do ladrão
2. Arruela moldada de borracha
3. Arruela de espuma
4. Arremate clássico do ladrão
5. Parafuso cabeça lenticular
6. Arremate contemporâneo do ladrão
7. Parafuso cabeça chata
8. Vedação de borracha
9. O-ring
10. Porca cromada
11. Tubo do ladrão
12. Tampa clic clac contemporânea do ralo
13. Tampa e corrente clássica do ralo
14. Tampa rosca
15. Parafuso cabeça chata
16. Grelha da válvula
17. Arruela de espuma
18. O-ring
19. Corpo do ralo
20. Arruela
21. Arruela de borracha
22. Corpo do sifão
23. Arruela
24. Arruela de borracha
25. Porca cromada
26. Tubo de escoamento
27. Arremate do tubo

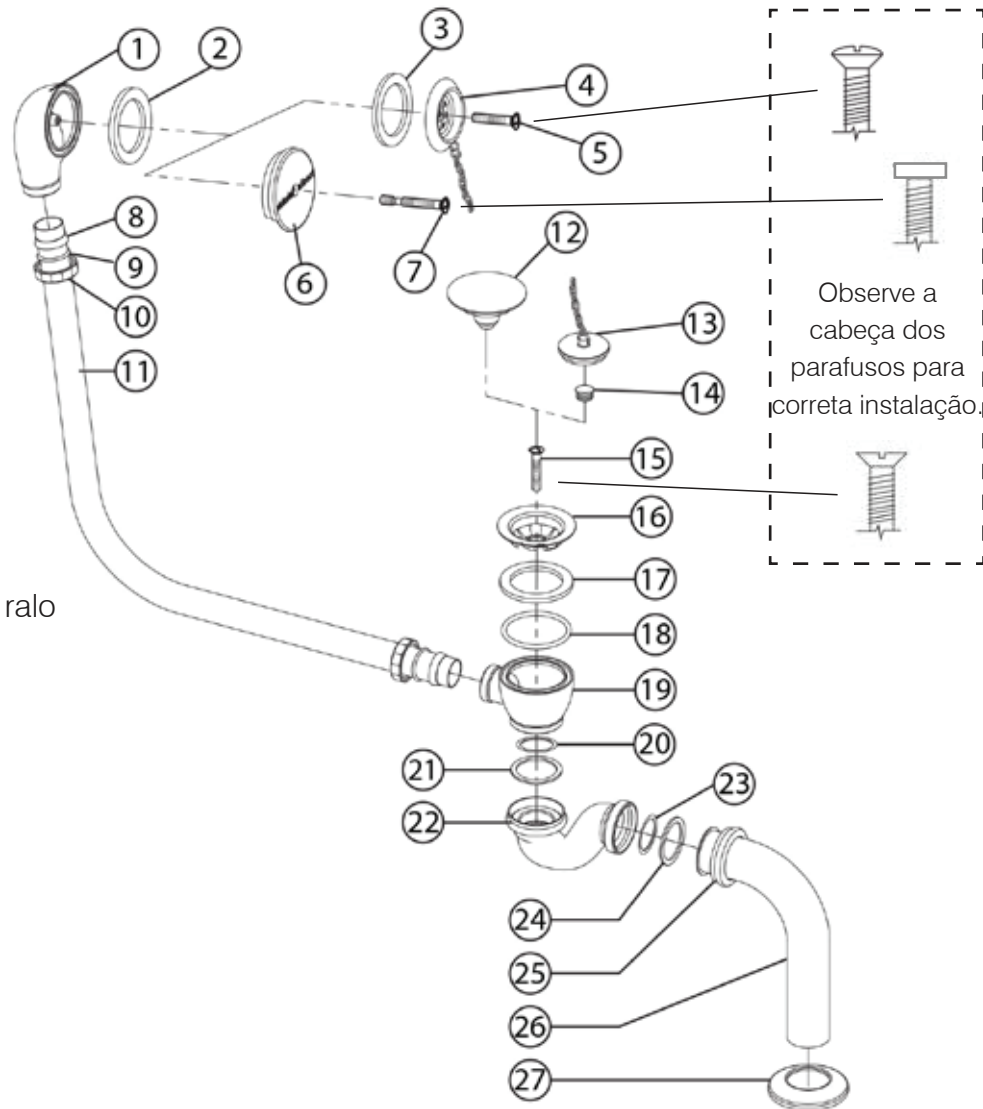
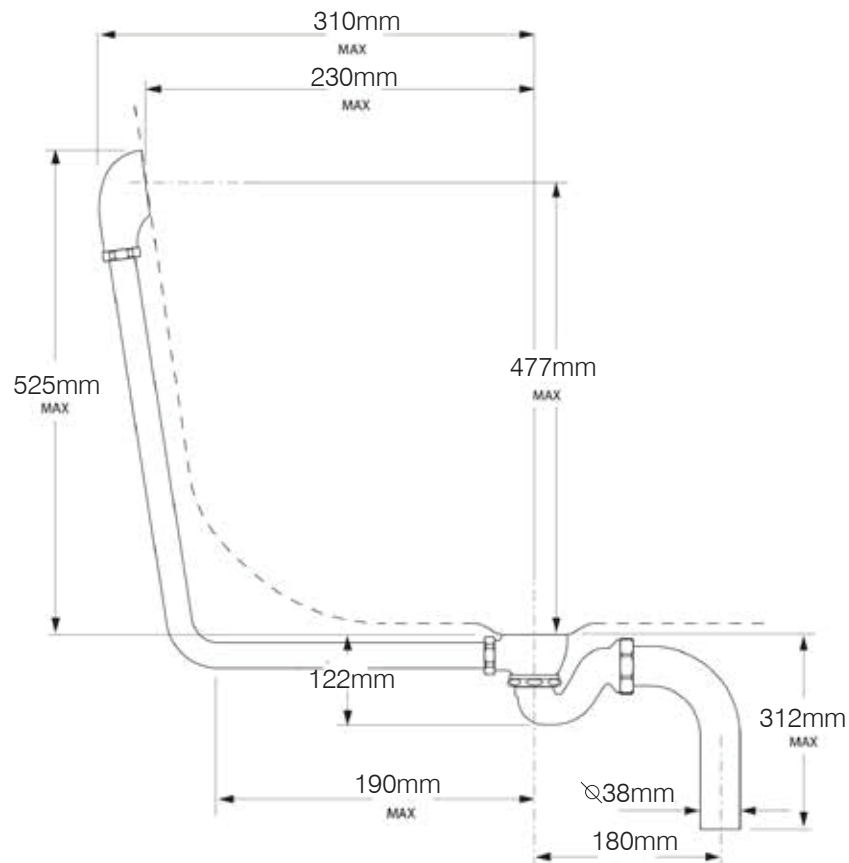
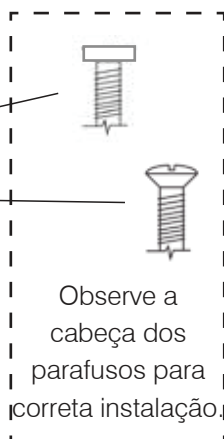
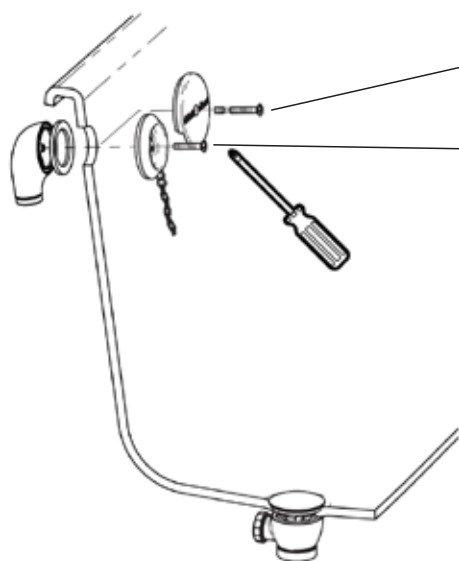

Medidas:

1

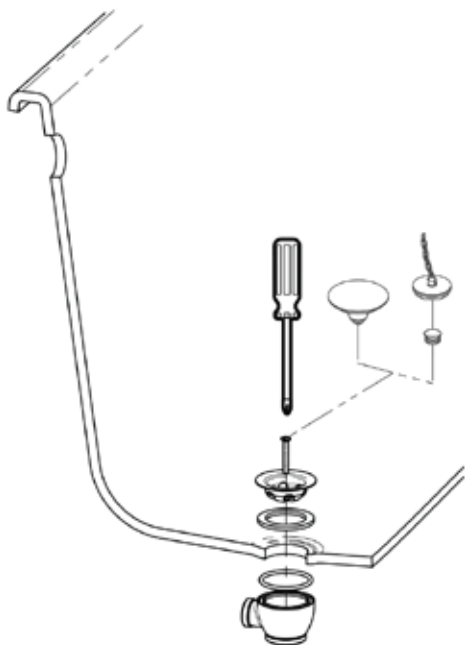

Observe a
cabeça dos
parafusos para
correta instalação.

2



3

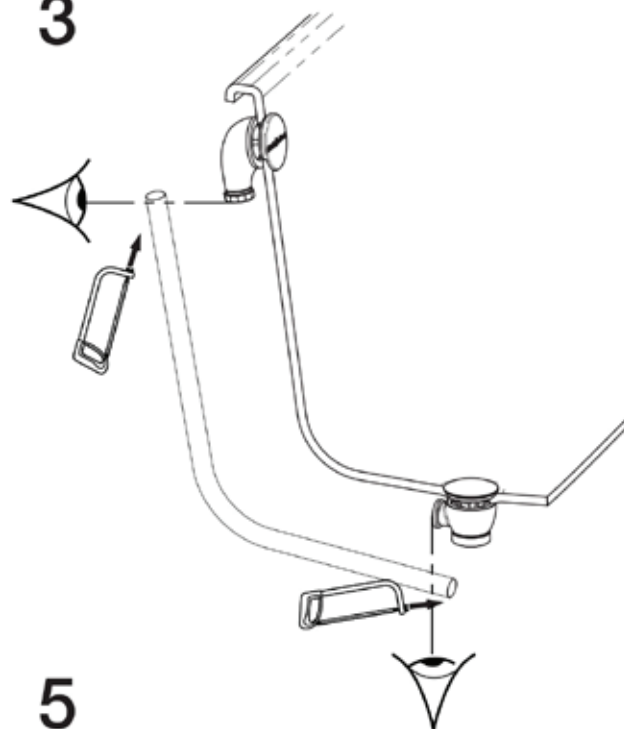

4

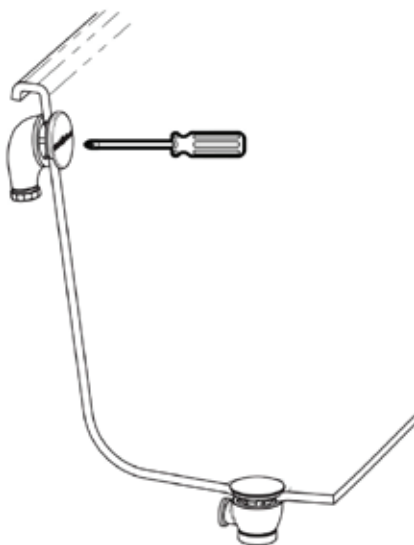

5

